

G0 – Planning



Planning - 01.xlsx



Planning - 02.xlsx



Planning - 03.xlsx



Planning - 04.xlsx



Planning - 05.xlsx



Planning - 06.xlsx



Planning - 07.xlsx



Planning - 08.xlsx



Planning - 01.xlsx



Planning - 02.xlsx



Planning - 03.xlsx



Planning - 04.xlsx



Planning - 05.xlsx



Planning - 06.xlsx

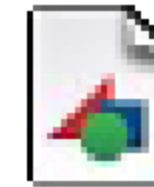

Planning - 07.xlsx



Planning - 08.xlsx



Planning - 01.xlsx



Planning - 02.xlsx



Planning - 03.xlsx



Planning - 04.xlsx



Planning - 05.xlsx



Planning - 06.xlsx



Planning - 07.xlsx



Planning - 08.xlsx

G1 – Well Design

G2 – Final Well Design

G3 – Well Execution Planning

G4 – Benchmarking

G5 – Well Construction Process

G6 – Well Handover Process

G7 – Rigless Well Intervention

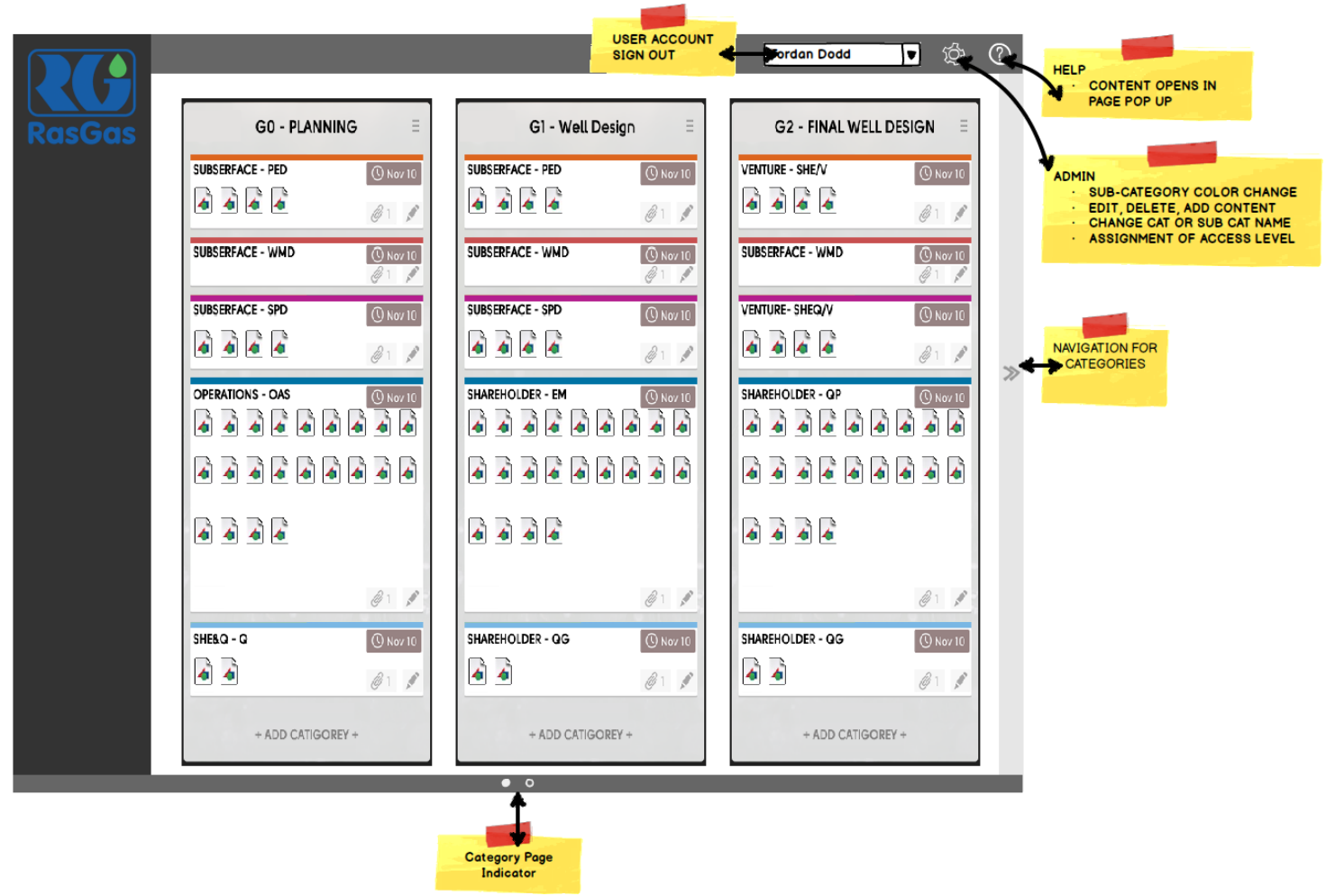
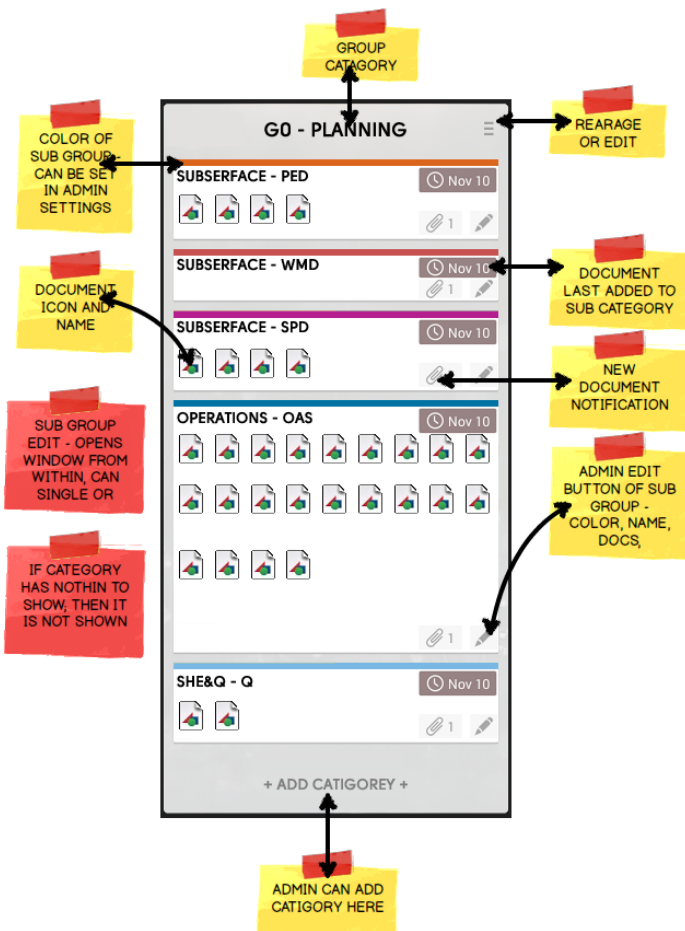



USER ACCOUNT
SIGN OUT

Jordan Dodd



HELP

- CONTENT OPENS IN PAGE POP UP

ADMIN

- SUB-CATEGORY COLOR CHANGE
- EDIT, DELETE, ADD CONTENT
- CHANGE CAT OR SUB CAT NAME
- ASSIGNMENT OF ACCESS LEVEL

NAVIGATION FOR
CATEGORIES

G0 - PLANNING

SUBSURFACE - PED

Nov 10



1

SUBSURFACE - WMD

Nov 10



1

SUBSURFACE - SPD

Nov 10



1

OPERATIONS - OAS

Nov 10

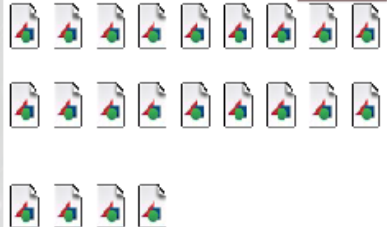

1

SHE&Q - Q

Nov 10



1

+ ADD CATIGOREY +

G1 - Well Design

SUBSURFACE - PED

Nov 10



1

SUBSURFACE - WMD

Nov 10



1

SUBSURFACE - SPD

Nov 10



1

SHAREHOLDER - EM

Nov 10

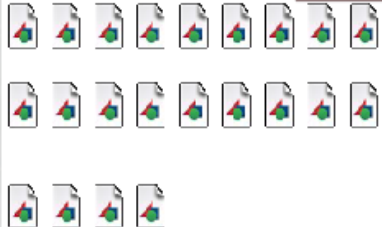

1

SHAREHOLDER - QG

Nov 10



1

+ ADD CATIGOREY +

GO - PLANNING

G1 - Well Design

G2 - FINAL WELL DESIGN

SUBSURFACE - PED

SUBSURFACE - PED

VENTURE - SHE/V

Help Documentation

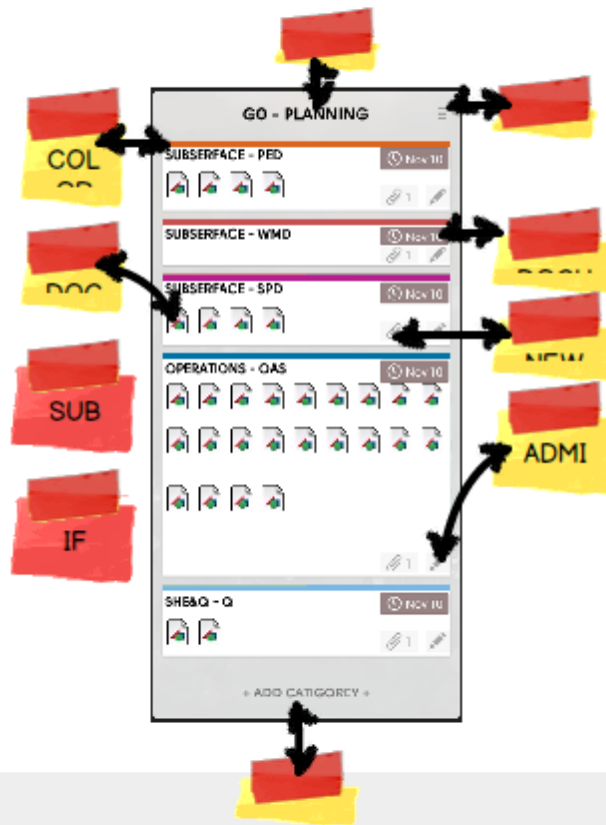

FAQS

Q - [Lorem ipsum dolor sit amet?](#)

A - Vis vero repudiare conclusionemque at.

Q - [Primis ridens deseruisse eos et?](#)

A - Elitr menandri forensibus est in. Nec an legendos aliquando.

Q - [Ex eam lorem graece, vim ex mutat audire?](#)

A - Cu mei illud nostro, vel ea nobis fuisset appellantur, sea invidunt erroribus disputando ut.

Q - [Ea sumo mentium definitionem eos?](#)

A - Te cibo adversarium eum.

Contact

G0 - PLANNING

G1 - Well Design

G2 - FINAL WELL DESIGN

SUBSURFACE - PED

SUBSURFACE - PED

VENTURE - SHE/V

Close Button

Contact Information

Corporate Headquarters: Houston, TX USA

The Information Store Main Number: +1 (713) 787-6798

General Fax Number: +1 (713) 787-6772

Support: +1 (800) 889-2312

Email: Support@istore.com

Mailing Address

The Information Store, Inc.
10777 Westhimer Rd., Suite 250
Houston, TX 77042-3476

Back to
documentation
Button

Documentation

Background
greyed out.

+ ADD CATIGOREY +

+ ADD CATIGOREY +

+ ADD CATIGOREY +

G0 - PLANNING | G1 - Well Design | G2 - FINAL WELL DESIGN

SUBSURFACE - PED | SUBSURFACE - PED | VENTURE - SHE/V

Category Selection

Close Button

Administration

General

User Name	Title	ID	Admin	G0	G1	G2	G3	G4	G5	G6	G7
Giacomo Guilizzoni	Developer	370061	<input type="checkbox"/>	<input checked="" type="checkbox"/>	<input type="checkbox"/>	<input type="checkbox"/>	<input checked="" type="checkbox"/>	<input checked="" type="checkbox"/>	<input type="checkbox"/>	<input checked="" type="checkbox"/>	<input checked="" type="checkbox"/>
Marco Botton	Software Developer	340852	<input checked="" type="checkbox"/>	<input type="checkbox"/>	<input checked="" type="checkbox"/>	<input checked="" type="checkbox"/>	<input checked="" type="checkbox"/>	<input checked="" type="checkbox"/>	<input type="checkbox"/>	<input type="checkbox"/>	<input type="checkbox"/>
Jordan Dodd	UI/UX Manager	132213	<input checked="" type="checkbox"/>	<input type="checkbox"/>	<input checked="" type="checkbox"/>	<input checked="" type="checkbox"/>	<input type="checkbox"/>	<input checked="" type="checkbox"/>	<input checked="" type="checkbox"/>	<input type="checkbox"/>	<input type="checkbox"/>
Ben Parker	Marketing Dir.	932243	<input checked="" type="checkbox"/>	<input checked="" type="checkbox"/>	<input checked="" type="checkbox"/>	<input checked="" type="checkbox"/>	<input checked="" type="checkbox"/>	<input checked="" type="checkbox"/>	<input checked="" type="checkbox"/>	<input checked="" type="checkbox"/>	<input checked="" type="checkbox"/>
Lora Wong	Business Developer	792202	<input type="checkbox"/>	<input type="checkbox"/>	<input type="checkbox"/>	<input type="checkbox"/>	<input type="checkbox"/>	<input type="checkbox"/>	<input type="checkbox"/>	<input checked="" type="checkbox"/>	<input checked="" type="checkbox"/>

Admin Selector

Sub Categories Permissions

Background greyed out.

+ ADD CATIGOREY +

GO - PLANNING

G1 - Well Design

G2 - FINAL WELL DESIGN

SUBSURFACE - PED

SUBSURFACE - PED

VENTURE - SHE/V

Administration

GO - Planning

GO - Planning

Sub Cat	Sub Cat Color	Sub Cat Sort	Active	Notification
Subsurface - PED	Sub Cat Color	1 Sorting	<input checked="" type="checkbox"/> Sub Cat Active	<input checked="" type="checkbox"/> Notification Active
Subsurface - WMD	Sub Cat Color	2 Sorting	<input checked="" type="checkbox"/> Sub Cat Active	<input type="checkbox"/> Notification Active
Subsurface - SPD	Sub Cat Color	3 Sorting	<input checked="" type="checkbox"/> Sub Cat Active	<input type="checkbox"/> Notification Active
Shareholder - QG	Sub Cat Color	4 Sorting	<input type="checkbox"/> Sub Cat Active	<input type="checkbox"/> Notification Active
Subsurface - BSD	Sub Cat Color	5 Sorting	<input checked="" type="checkbox"/> Sub Cat Active	<input checked="" type="checkbox"/> Notification Active
Subsurface - CID	Sub Cat Color	6 Sorting	<input checked="" type="checkbox"/> Sub Cat Active	<input checked="" type="checkbox"/> Notification Active
Operations - OAS	Sub Cat Color	7 Sorting	<input type="checkbox"/> Sub Cat Active	<input checked="" type="checkbox"/> Notification Active
Shareholder - EM	Sub Cat Color	8 Sorting	<input checked="" type="checkbox"/> Sub Cat Active	<input checked="" type="checkbox"/> Notification Active

Change Sub Cat Name

Change Color Indicator

Change sort of Sub Cat

Activate Sub Cat

Activate Notification

+ ADD CATIGOREY +

+ ADD CATIGOREY +

+ ADD CATIGOREY +

Category Selection

Close Button

Change Cat Name

Background greyed out.

GO - PLANNING

SUBSURFACE - PED Nov 10

SUBSURFACE - WMD Nov 10

G1 - Well Design

SUBSURFACE - PED Nov 10

SUBSURFACE - WMD Nov 10

G2 - FINAL WELL DESIGN

VENTURE - SHE/V Nov 10

SUBSURFACE - WMD Nov 10

User Account

Change User Name

Change Password

Whatever the user account settings look like.

Save Settings

A non-boring JS confirmation window when clicked.

Close Button

Save Settings button. UI spinner icon to show it is clicked.

SHE&Q - Q Nov 10

SHAREHOLDER - QG Nov 10

SHAREHOLDER - QG Nov 10

+ ADD CATIGOREY +